

***Friends Meeting House, Kirkbymoorside***

*79 West End, Kirkbymoorside, York, YO62 6AD*

*National Grid Reference: SE 69437 86382*



***Statement of Significance***

***The meeting house was built in 1690 and almost completely rebuilt in 1790, with new fittings. The attached burial ground also dates from 1690. The building was given a new porch, probably c1810. The building still retains much of its original character, including the interior, and is of high heritage significance.***

**Evidential value**

***The main fabric of the building probably incorporates elements of the 1690s meeting house and the interior still contains many elements of the original 1790s arrangements; overall the building has high evidential value.***

**Historical value**

***A well-preserved example of a small late eighteenth-century town-centre meeting house, which is of high historical value.***

**Aesthetic value**

***The stone exterior of the building is largely concealed from public view and makes only a modest contribution to the character of the Conservation Area. The interior still preserves a great deal of its original character. The building is of high aesthetic value.***

**Communal value**

***The site has been used for Quaker worship continuously since 1690.. It is now also used for other community activities and has high communal value.***

**Part 1: Core data**

1.1 Area Meeting: *Pickering & Hull*

1.2 Property Registration Number: *0012790*

1.3 Owner: *Area Meeting*

1.4 Local Planning Authority: *Ryedale District Council*

1.5 Historic England locality: *Yorkshire*

1.6 Civil parish: *Kirkbymoorside*

1.7 Listed status: *II*

1.8 NHLE: *1149242*

1.9 Conservation Area: *Kirkbymoorside*

1.10 Scheduled Ancient Monument: *No*

1.11 Heritage at Risk: *No*

1.12 Date(s): *1790*

1.13 Architect (s): *Not established*

1.14 Date of visit: *1 April 2016*

1.15 Name of report author: *Neil Burton*

1.16 Name of contacts made on site: *Helen Beaumont & Mary Rowlands*

1.17 Associated buildings and sites: *Warden's cottage in row of cottages between the meeting house and the street. Detached burial ground at Lowna in Farndale.*

1.18 Attached burial ground: Yes

1.19 Information sources:

Butler, D.M., *The Quaker Meeting Houses of Britain*, 1999, vol.2 pp.741-3.

Mary Rowlands, *The Quakers of Kirkbymoorside and district 1652-1990* (1990).2<sup>nd</sup> ed. 2009

Stell Christopher, *Nonconformist Chapels and Meeting houses in the North of England*,

*RCHM* 1994. pp.212

North Yorkshire County Historic Environment Record ref. DNY 9265

Local Meeting survey by Helen Beaumont, 26 January 2016

## Part 2: The Meeting House & Burial Ground: history, contents, use, setting and designation

### 2.1. Historical background

Quakers registered a meeting place in Kirkbymoorside in 1689 and in 1690 they obtained land for a burial ground and erected a small new meeting house on part of it. By the later eighteenth century this building was much out of repair and in 1789/90 it was largely rebuilt, apparently incorporating some of the earlier fabric. The roof was raised and the thatch was replaced with slate. The interior was completely re-fitted with new sash windows, timber panelling, loft and elders' stand. At some time in the early nineteenth century a small brick porch was added to the west side. The porch also houses the stair to the internal gallery.

Attendance at Meeting for Worship was greatly reduced in the latter half of the 19<sup>th</sup> century and the administration of the Meeting was taken over by Pickering or Malton, and for a period Kirkbymoorside Meeting was only held on the first Sunday of the month. The meeting revived c1930

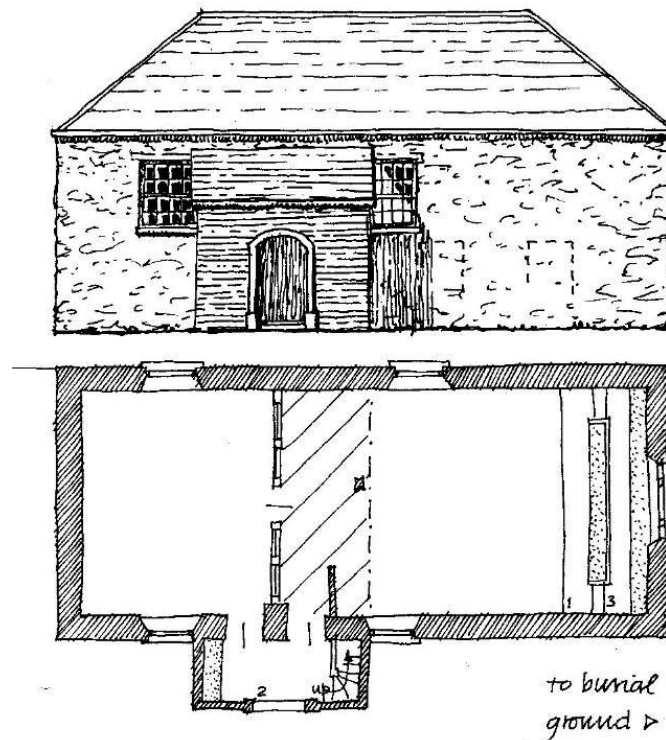

Fig.1 West elevation and plan of the meeting house, *Butler* 1999 vol.2 p.742, (north is to the left).

### 2.2. The building and its principal fittings and fixtures

The meeting house is hidden from the street behind a row of cottages and reached through an opening with the date 1861 on the rear lintel. The meeting house is a modest building, rectangular on plan, with walls of coursed sandstone rubble and a hipped roof covered with Welsh slate. The main entrance is on the long west side with two separate doorways sheltered by a small red brick porch with a round-headed doorway and a lean-to roof. On the south side of the porch is a sundial dated 1810, which could be the date of the porch itself. Hard on each side of the porch, set high in the wall, are two rectangular window openings with 8/8 small-pane timber sashes. In the south end wall is a triple-sash window. At the north end is a modern stone-built lean-to addition containing the WCs. The east rear wall, which forms the boundary with the adjoining property, also has two sash windows.

The interior is divided into two unequal compartments by a panelled timber screen. The larger southern space is the main meeting room which has a dado of raised and fielded timber panelling, now painted, ramped up at the south end for two tiers of Elders' benches. At the north end of the room is a loft or gallery with an open timber balustrade; it now has a modern safety handrail and there is a modern glazed enclosure to the gallery stair (which rises from the front porch). The smaller space at the north end of the building was originally the Women's Meeting Room (at a meeting in 1789 it was resolved that 'the lesser end be made a pretty comfortable place for women Friends to meet in...'). It retains a timber panelled dado and hinged square panels opening into the main space under the gallery, but the upper part of the screen wall is now plain plastered and modern kitchen fittings have been inserted across the north wall.

### 2.3. Loose furnishings

There are six old timber open-back benches in the meeting house and a further four in Ryedale Folk Museum. All of them probably date from 1789.

### 2.4. Attached burial ground (if any)

The burial ground behind the meeting house is uniform in size with the gardens of adjacent houses and is managed as a garden. There is one surviving burial marker although many burials were recorded, from 1690 and later

### 2.5. The meeting house in its wider setting

The meeting house is completely hidden from West End, behind a row of two-storey cottages on the south side of the street. Entrance is by means of a passage below one of the cottages, which is clearly later than the rest; the lintel of the south entrance to the passage has the date 1861. This cottage is occupied by the warden. It is not included on the statutory list and appears to be partly eighteenth century and partly of 1861. The meeting house burial ground is the same size as the gardens behind the cottages.

There is a detached burial ground at a remote spot at Lowna in Farndale, near Hutton le Hole (National Grid Reference SE 6862891423) which was used for burials from 1675

### 2.6. Listed status

The building is properly listed at Grade II.

### 2.7. Archaeological potential of the site

The site is close to the town centre and should probably be considered as of medium archaeological potential (North Yorkshire County Heritage Environment Record ref. DNY 9265).

## **Part 3: Current use and management**

### 3.1. Condition

i) Meeting House: Good

ii) Attached burial ground (if any): Optimal. The burial ground is managed as a garden.

### 3.2. Maintenance

The Last Quinquennial Inspection was made in 2012 by a suitably qualified person. All the recommended works have been carried out.

### 3.3. Sustainability

The meeting does not use the Sustainability Toolkit, but has implemented measures to reduce its environmental impact. These include a new heating system; change to sustainable supplier 'Good Energy'; car sharing for distant area meetings.

Neither the meeting house nor the separate Warden's Cottage have an EPC and the meeting would not consider obtaining one.

### 3.4. Amenities

The meeting has all the amenities it needs in the meeting house - including meeting rooms, kitchen and toilets. Children's activities (if any) are held in the adjacent cottage of the resident Warden.

The meeting house is in central Kirkbymoorside. Access from York by public transport is very limited and not direct. The nearest rail station is 15 miles away. There is on-street parking nearby and the town car park is only 5 minutes walk. There is no secure storage for bicycles.

### 3.5. Access

There is level access to all parts of the building (except the gallery).

### 3.6 Community Use

Friends use the building for approximately 3 hours per week. The meeting house is available for hire for a theoretical total of 78 hours per week (6 x 13) and is used for approximately 5 hours per week. The meeting does have a lettings policy; no alcohol is permitted, nor the use of candles. Quaker groups have free use. Users value the good location with secluded garden, reasonable rent and the fact that children are welcome.

### 3.7. Vulnerability to crime

There has been no evidence of general crime or heritage crime. There was one incident where a window was broken which was reported to the local police. The area is generally well cared-for, has low crime levels, low deprivation and high community confidence,

### 3.8. Plans for change

There are no plans for change.

## **Part 4: Impact of Change**

### 4.1. To what extent is the building amenable or vulnerable to change?

*i) As a Meeting House used only by the local Meeting:* The meeting house is a small building with an interior which is relatively intact and offers little scope for significant change. There may be some scope for minor change, subject to listed building constraints.

*ii) For wider community use, in addition to local Meeting use:* as above, there may be scope for minor alterations, subject to listed building constraints.

*iii) Being laid down as a Meeting House:* A new use would be needed for the building if the meeting were laid down, as it has high heritage value, but it occupies a small town-centre site with many constraints including being listed.

## **Part 5: Category: 2**

### **Part 6: List description**

Name: **FRIENDS MEETING HOUSE AT REAR OF 79 WEST END**

List entry Number: 1149242

Location

FRIENDS MEETING HOUSE AT REAR OF 79, WEST END

The building may lie within the boundary of more than one authority.

County: North Yorkshire

District: Ryedale

District Type: District Authority

Parish: Kirkbymoorside

National Park: Not applicable to this List entry.

Grade: II

Date first listed: 05-Jun-1985

List entry Description

SE 6886-6986 KIRKBYMOORSIDE WEST END (south side)

6/71 Friends' Meeting House at rear of No 79

II

Quaker meeting house. 1791. Coursed sandstone, with porch of orange brick in stretcher bond; slate roof. 2-cell rectangular building, with west porch. Porch: round-arched entrance with timber surround with paired, panelled doors, staircase within. 16-pane sashes under thin timber lintels on either side. Similar windows to rear. In right return wall is a tripartite sash with glazing bars. Hipped roof. Interior: original fittings include panelled gallery; raised up Elders' benches; dado panelling. On the south wall of the porch is an iron and timber sundial, slightly canted. The inscription reads: 'J, Russell. Dd. MDCCCX'.

Listing NGR: SE6943786382